

1. Package Contents

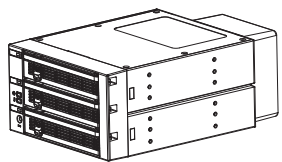

Product

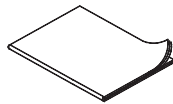

Manual

Accessory bag

Button head #6-32 12 pcs

Flat head #6-32 12 pcs

2. Front Panel's LED Indicate Instruction

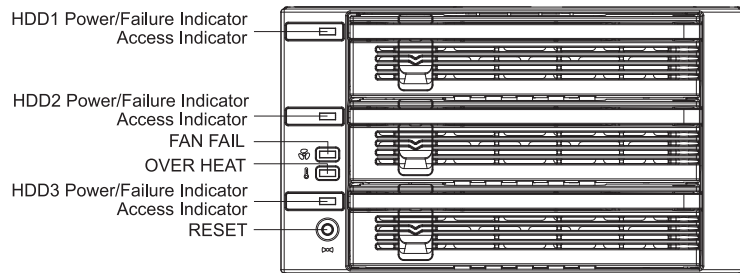

2.1. The Front Panel HDD LED Signal lights are based on three colors in one.

2.1.1 When the HDD is attached to the tray the LED will show green light, which means the power is active.

2.1.2 When HDD is writing or reading the LED will show flashing orange light, which mean HDD is operating.

2.1.3 When HDD Fails the LED will show red light, which means HDD is damage or non-functional (This signal should be provided by the HOST Please refer to image 2.3)

2.2 HDD Fail signal access

2.2.1 This product can not provide the signal, unless the HOST (motherboard or controller card) supports this function.

2.2.2 If the HOST can provide HDD fail signal, the access cable needs to be connect to the HOST and to the backplane HDD Fail in pin.

2.2.3 When the HDD is damage, it will show red light color (This signal should be provided by the HOST).

2.3 Cooling Fan damaged and product overheat warning: Cooling Fan's Characteristic: This product is designed to be replaceable or interchangeable, it does not require to turns off power to replace a new one or remove completely.

2.3.1 When Cooling fan stops running or fail, the fan fail light will display red light and then the alarm will start to buzz. To stop the buzz alarm you must push the reset button, but the red light will still be display until the Fan is removed or replaced.

2.3.2 If cooling Fan is not installed, the fan failure alarm will not transmit any signal.

2.3.3 When the product temperature exceeds the temperature set. The light will appear in red and the buzz will start, if this issue occurs please press RESET to stop the buzzer. But the OVER HEAT light will be turn on (Red Color Light), until the temperature is below the temperature setting.

3. Back Plane Description (Labeled display on the top side of the Product)

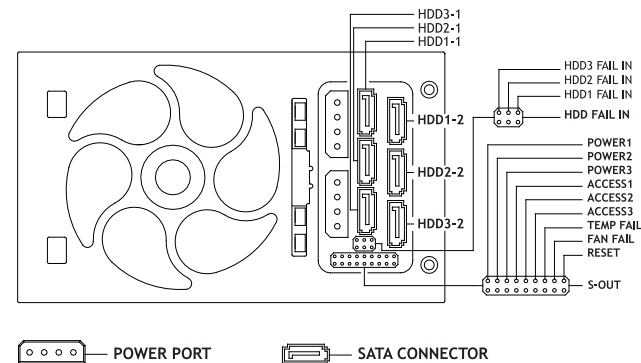

4. Operating Instructions

A. Slide down the eject button, the handle will eject, then remove the tray

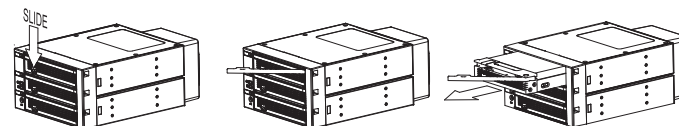

B. Remove the support rail and secure HDD to the removable tray and reinsert the tray back into the device unit.

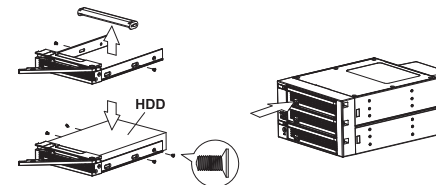

C. The Cooling Fan is removable when it is not needed. After the Cooling Fan is removed the FAN FAIL system and alarm will not transmit any signal.

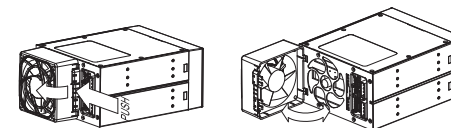

* Back panel instructions: Please connect 2 x 4 PIN Power Supply as the main power source to fully enable device.

Note:

- HDD failure will indicate red only when the signals are transmitted by HOST (Please refer to the HDD-fail Signal access 2.2)
- The testing condition were at the surrounding temperature at 25 °C
- ICY DOCK reserved the right to changes any unrelated in the technical specification are subject to change without prior notice.
- ICY DOCK will not be liable for any software, hardware and any data stored within or interfacing with our product which resulted to being damaged or dysfunctional. ICY DOCK will only be responsible to repair and service its own product.
- For any further inquiries about ICY DOCK product or related product information, please visit <http://www.icydock.com>.